

<Flat Top type>

Hydraulic pulverizer PAT

MC Pulverizer

MC-75-TFT | MC-135-TFT | MC-452-TFT

Operation & Maintenance Manual

This manual is limited to the flat-top type.
Refer also to Operation & Maintenance Manual, which covers all types.

Contents

Specifications and Dimensions	2
Flat Top Type	2
Interface Specifications	3
Flat Top Type	3
Component names	6
Flat Top Type	6
Greasing	7
Lubrication points.....	7

TAGUCHI®

Specifications and Dimensions

Flat Top Type

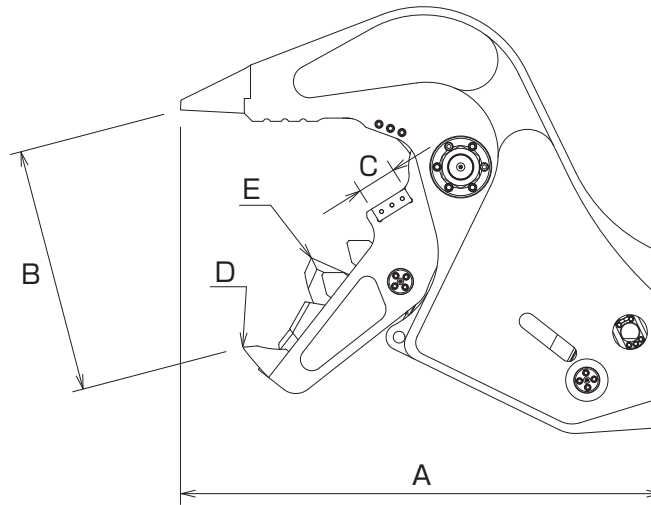

Model name		MC-75-TFT	MC-135-TFT	MC-452-TFT
Class of excavator	ton	6 - 8	12 - 14	40 - 45
Operating pressure	MPa (kgf/cm ²)	24.5 (250)	31.4 (320)	
Max. operating pressure	MPa (kgf/cm ²)	27.4 (280)	34.3 (350)	
Required flow rate	L/min	140	240	800
A Length	mm	1270	1480	2290
B Maximum jaw opening	mm	620	750	1200
C Cutting blade length	mm	100	120	210
D Crushing force at tip	kN (tf)	369 (38)	547 (56)	1380 (223)
E Crushing force at center	kN (tf)	534 (55)	882 (90)	2190 (141)
Mass	kg	580	1020	3940

- Single two-way hydraulic piping is required.
- We recommend reinforcing the stick of a hydraulic excavator that has this product installed.
- The weights in the table are reference values. For the weight of products, refer to “Product name-plates”.
- The attachment cannot be installed on a hydraulic excavator of a different class.

Diameter of rebar that can be cut by the MC Pulverizer

(Units: mm)

Model name	MC-75-TFT	MC-135-TFT	MC-452-TFT
Rebar diameter	φ25	φ32	φ51

Interface Specifications

Flat Top Type

• MC-75-TFT

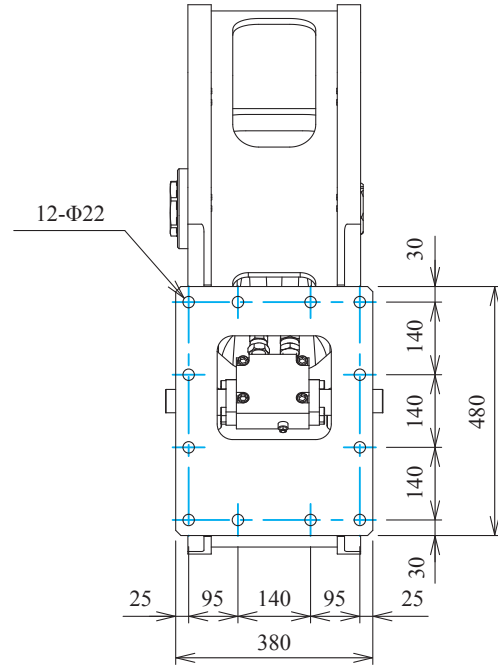
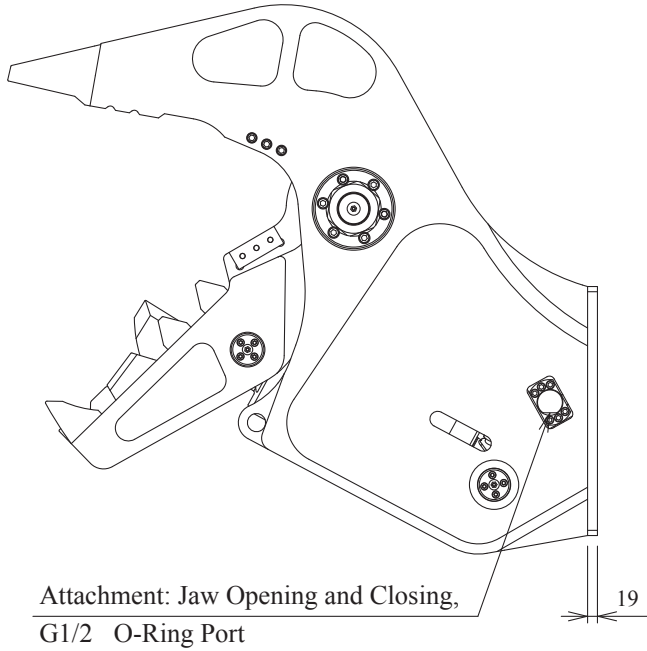

Attachment: Jaw Opening and Closing,
G1/2 O-Ring Port

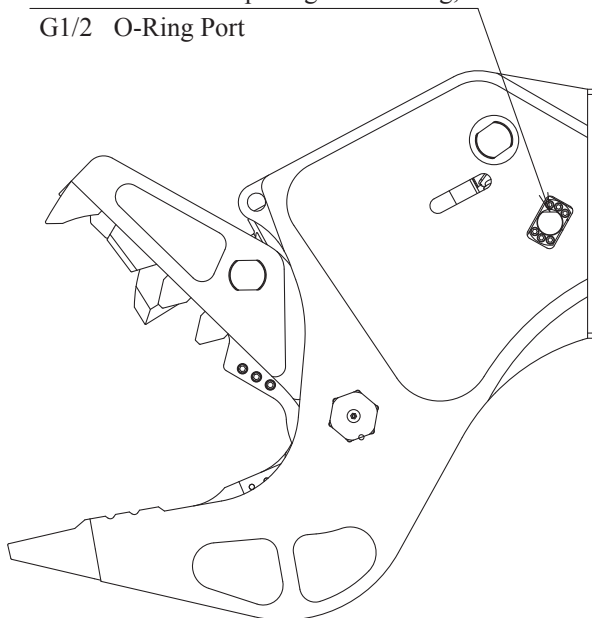

● MC-135-TFT

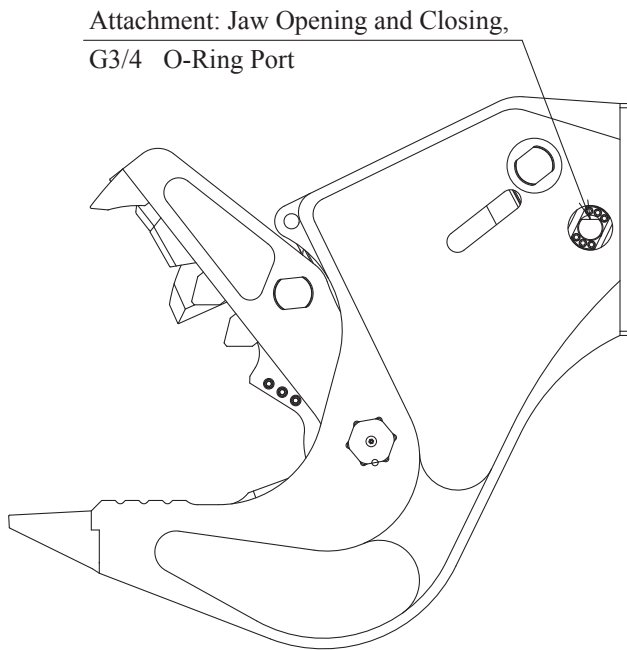
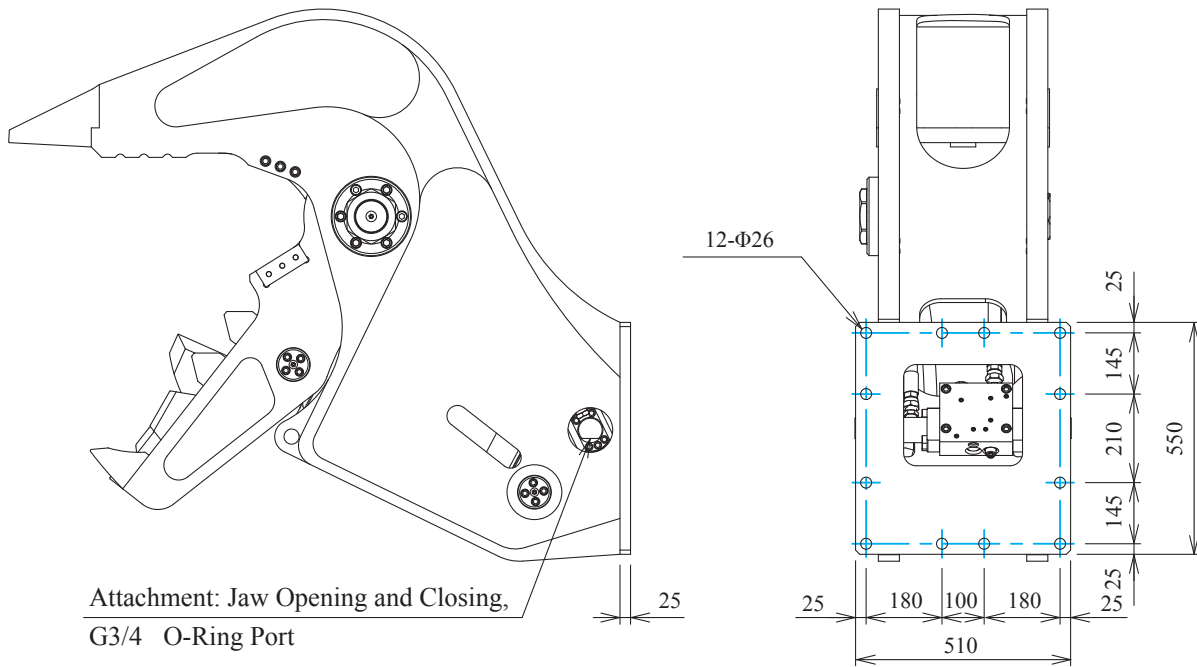

● MC-452-TFT

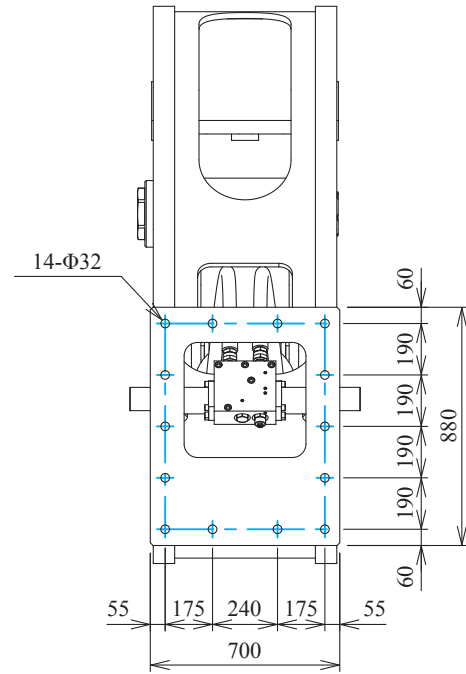
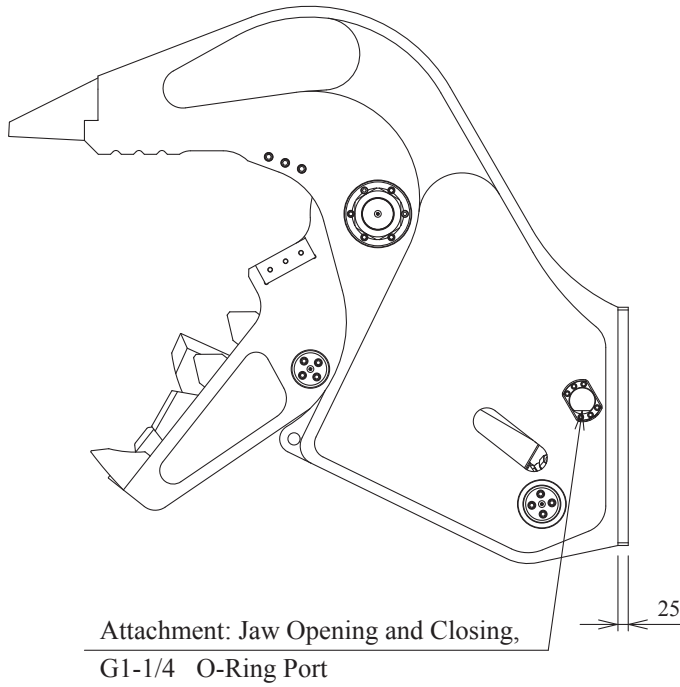

Attachment: Jaw Opening and Closing,
G1-1/4 O-Ring Port

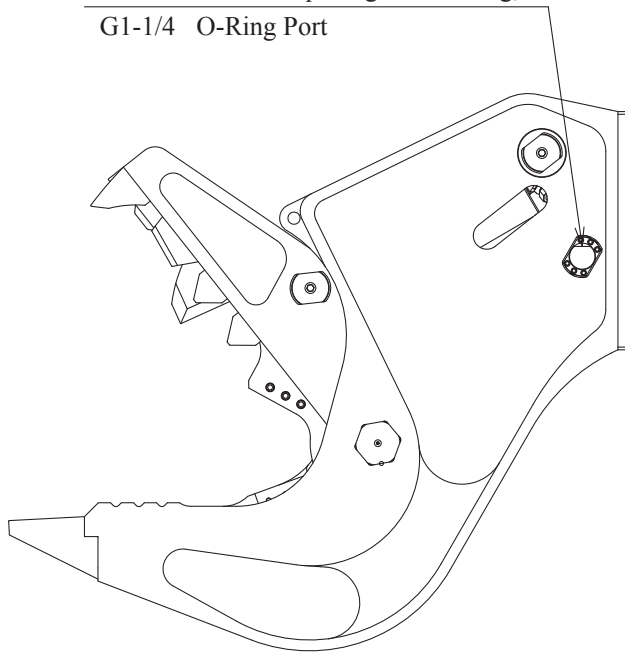

Component names

Flat Top Type

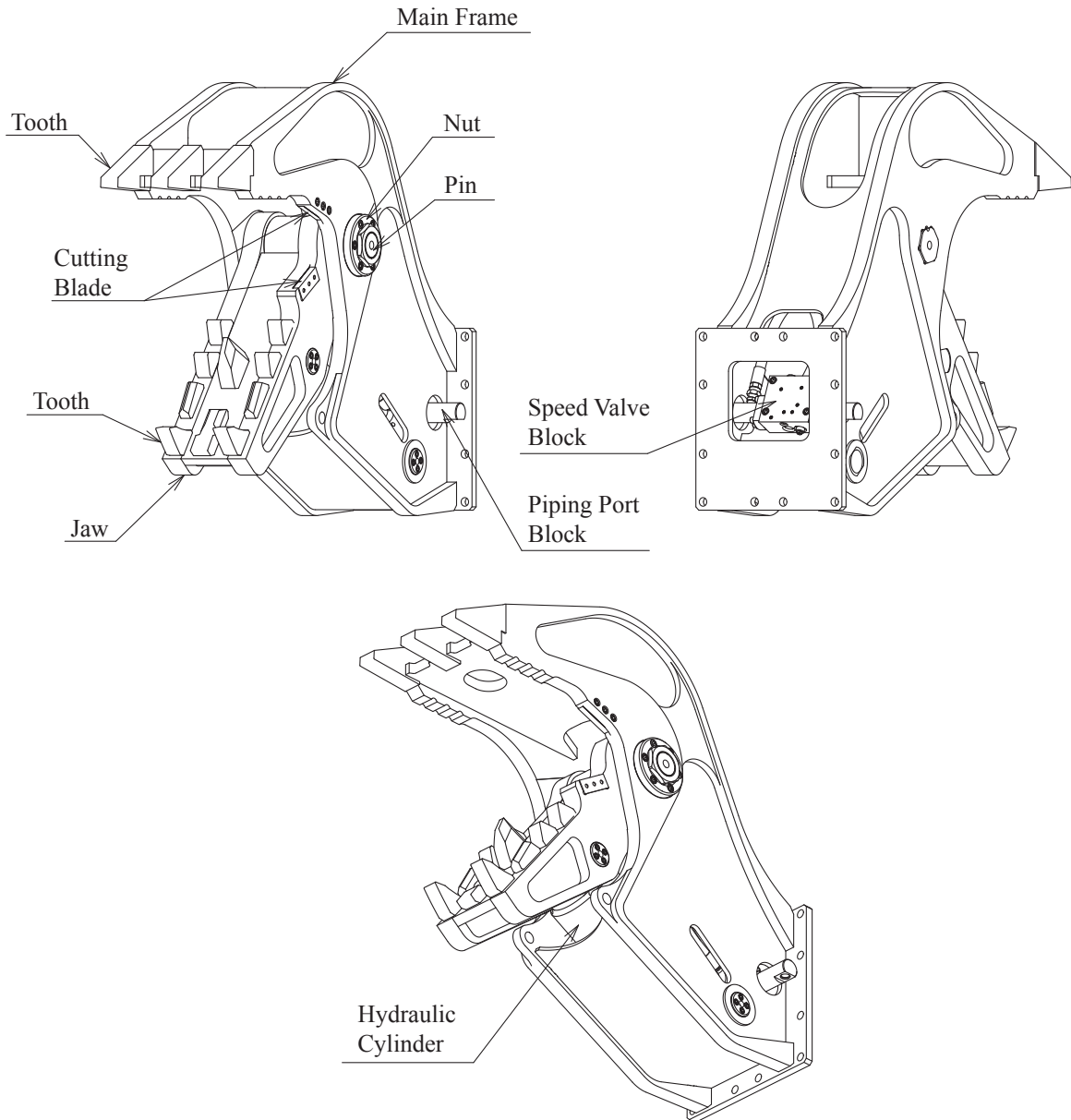

Greasing

■ Lubrication points

Apply grease at the numbered locations in the drawing.

- **Flat Top Type**

- MC-75-TFT/MC-135-TFT/MC-452-TFT

